

SHIELDED SMD POWER INDUCTORS / SDR TYPE

FEATURES

- ◆ Low DC resistance and for large currents & low profile.

APPLICATIONS

- ◆ Power supply for VTRs.
- ◆ Portable communication equipment.
- ◆ Notebook PCs.
- ◆ LCD televisions.
- ◆ DC/DC converters, etc.



ORDERING CODE

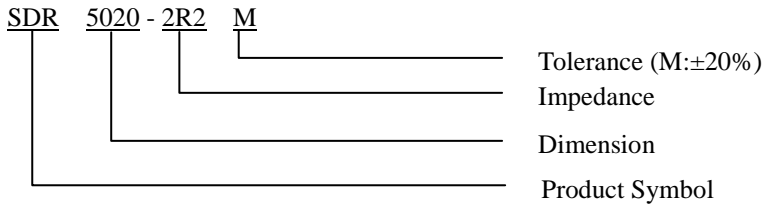

SHAPE

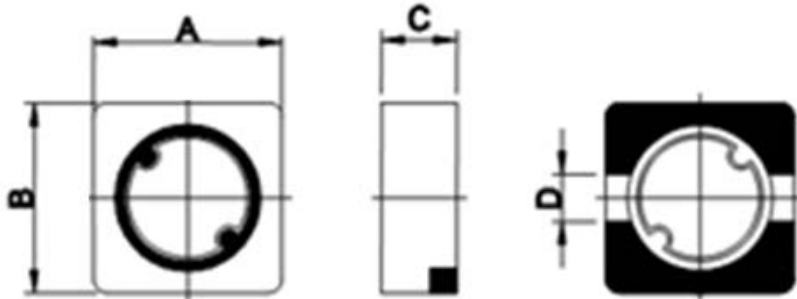

DIMENSIONS UNIT: mm

Part No.	A (MAX)	B (MAX)	C (MAX)	D (REF)
SDR5020	5.3	5.3	2.0	2.0
SDR5030	5.3	5.3	3.0	2.0

SHIELDED SMD POWER INDUCTORS / SDR TYPE

ELECTRICAL CHARACTERISTICS FOR SDR5020

Part No.	Inductance (μ H)	Test Frequency	DC Resistance (Ω) Max	IDC (A) Max
SDR5020-1R0	1.0	100KHz / 0.25V	0.030	2.700
SDR5020-1R2	1.2	100KHz / 0.25V	0.044	2.150
SDR5020-2R0	2.0	100KHz / 0.25V	0.046	1.900
SDR5020-2R2	2.2	100KHz / 0.25V	0.059	1.630
SDR5020-2R7	2.7	100KHz / 0.25V	0.060	1.550
SDR5020-3R3	3.3	100KHz / 0.25V	0.062	1.500
SDR5020-3R5	3.5	100KHz / 0.25V	0.073	1.340
SDR5020-4R1	4.1	100KHz / 0.25V	0.081	1.200
SDR5020-4R7	4.7	100KHz / 0.25V	0.087	1.140
SDR5020-5R6	5.6	100KHz / 0.25V	0.093	1.000
SDR5020-6R8	6.8	100KHz / 0.25V	0.105	0.950
SDR5020-8R2	8.2	100KHz / 0.25V	0.139	0.900
SDR5020-100	10	1KHz / 0.25V	0.150	0.760
SDR5020-120	12	1KHz / 0.25V	0.170	0.660
SDR5020-150	15	1KHz / 0.25V	0.210	0.630
SDR5020-220	22	1KHz / 0.25V	0.275	0.560
SDR5020-330	33	1KHz / 0.25V	0.455	0.440
SDR5020-390	39	1KHz / 0.25V	0.540	0.380
SDR5020-470	47	1KHz / 0.25V	0.730	0.350
SDR5020-560	56	1KHz / 0.25V	0.800	0.320
SDR5020-680	68	1KHz / 0.25V	0.935	0.300
SDR5020-101	100	1KHz / 0.25V	1.500	0.230
SDR5020-121	120	1KHz / 0.25V	1.910	0.220
SDR5020-151	150	1KHz / 0.25V	2.680	0.210
SDR5020-181	180	1KHz / 0.25V	3.045	0.200
SDR5020-221	220	1KHz / 0.25V	3.520	0.195
SDR5020-271	270	1KHz / 0.25V	4.380	0.193
SDR5020-331	330	1KHz / 0.25V	5.560	0.190
SDR5020-471	470	1KHz / 0.25V	7.820	0.180
SDR5020-561	560	1KHz / 0.25V	9.790	0.170
SDR5020-821	820	1KHz / 0.25V	15.000	0.120

CORE MASTER ENTERPRISE CO., LTD.

<http://www.coremaster.com.tw>



SHIELDED SMD POWER INDUCTORS / SDR TYPE

ELECTRICAL CHARACTERISTICS FOR SDR5030

Part No.	Inductance (μ H)	Test Frequency	DC Resistance (Ω) Max	IDC (A) Max
SDR5030-1R0	1.0	100KHz / 0.25V	0.015	4.00
SDR5030-1R1	1.1	100KHz / 0.25V	0.020	3.87
SDR5030-1R2	1.2	100KHz / 0.25V	0.022	3.80
SDR5030-2R0	2.0	100KHz / 0.25V	0.027	2.92
SDR5030-2R2	2.2	100KHz / 0.25V	0.029	2.41
SDR5030-3R3	3.3	100KHz / 0.25V	0.034	2.36
SDR5030-4R7	4.7	100KHz / 0.25V	0.045	1.87
SDR5030-5R6	5.6	100KHz / 0.25V	0.052	1.60
SDR5030-6R8	6.8	100KHz / 0.25V	0.068	1.51
SDR5030-8R2	8.2	100KHz / 0.25V	0.084	1.38
SDR5030-100	10	1KHz / 0.25V	0.090	1.33
SDR5030-120	12	1KHz / 0.25V	0.125	1.08
SDR5030-150	15	1KHz / 0.25V	0.142	1.05
SDR5030-180	18	1KHz / 0.25V	0.160	0.95
SDR5030-220	22	1KHz / 0.25V	0.208	0.86
SDR5030-270	27	1KHz / 0.25V	0.222	0.75
SDR5030-330	33	1KHz / 0.25V	0.257	0.72
SDR5030-470	47	1KHz / 0.25V	0.352	0.62
SDR5030-680	68	1KHz / 0.25V	0.525	0.51
SDR5030-101	100	1KHz / 0.25V	0.801	0.43
SDR5030-121	120	1KHz / 0.25V	0.850	0.34
SDR5030-151	150	1KHz / 0.25V	1.100	0.26
SDR5030-181	180	1KHz / 0.25V	1.190	0.24
SDR5030-221	220	1KHz / 0.25V	1.530	0.20
SDR5030-331	330	1KHz / 0.25V	2.030	0.19
SDR5030-391	390	1KHz / 0.25V	3.000	0.16
SDR5030-471	470	1KHz / 0.25V	3.500	0.15
SDR5030-561	560	1KHz / 0.25V	4.450	0.14

CORE MASTER ENTERPRISE CO., LTD.



<http://www.coremaster.com.tw>